



PFC Device Corporation

PCR6S650TD

6A 650V SiC Schottky Rectifier

Major ratings and characteristics

Characteristics	Values	Units
I_F	6	A
$V_{DC, max.}$	650	V
$Q_C; V_R=400V$	18	nC, typ.
$T_{J, max.}$	175	°C

Features

- Higher efficiency
- Near zero switching loss
- Reliable High Temperature Operation
- 175°C Operating Junction Temperature
- Lead Free Finish, RoHS Compliant
- Green Molding Compound (No Br, Sb)

Typical Applications

- Switching mode power supply, UPS
- Power Factor Correction
- DC-DC Converter
- Output rectification
- Data Center

PCR6S650TD

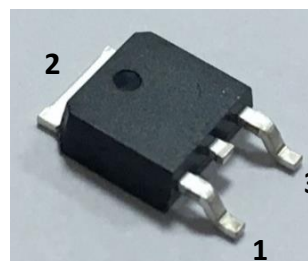

TO-252 (DPAK)

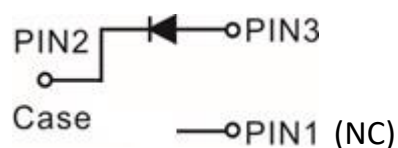

1. Characteristics

Maximum Ratings Characteristics, at $T_C = 25^\circ\text{C}$ unless otherwise specified

Parameter	Symbol	Values	Units
Peak Repetitive Reverse Voltage	V_{RRM}	650	Volts
Continuous Forward Current for $R_{thJC, max.}$	I_F	6	Amps
Non-Repetitive Forward Surge Current, sine half wave $T_C=25^\circ\text{C}$, $t_p=10\text{ms}$ $T_C=110^\circ\text{C}$, $t_p=10\text{ms}$	I_{FSM}	66 57	Amps
i^2t value $T_C=25^\circ\text{C}$, $t_p=10\text{ms}$ $T_C=110^\circ\text{C}$, $t_p=10\text{ms}$	$\int i^2 dt$	21 16	A^2s
Power Dissipation, $T_C=25^\circ\text{C}$ $R_{\theta JC}$ typ.	P_{tot}	75	W
Operating Junction Temperature	T_J	- 55 to +175	$^\circ\text{C}$
Storage Junction Temperature	T_{STG}	- 55 to +175	

Thermal Characteristics

Parameter	Symbol	Typ.	Max.	Units
Thermal Resistance, Junction to Case	$R_{\theta JC}$	2	---	$^\circ\text{C} / \text{W}$
Thermal Resistance, Junction to Ambient	$R_{\theta JA}$	---	65	
Soldering Temperature, wave soldering only allowed at leads (1.6mm from case for 10s)	T_{solder}		260	$^\circ\text{C}$



Electrical Characteristics , at $T_A = 25^\circ\text{C}$ unless otherwise specified

Static Characteristics

Characteristics	Test Conditions	Symbol	Min.	Typ.	Max.	Units
DC Blocking Voltage	$I_R=0.5\text{mA}$, $T_J=25^\circ\text{C}$	V_{DC}	650	---	---	Volts
Diode Forward Voltage	$I_F=3\text{A}$, $T_J = 25^\circ\text{C}$	V_F	---	1.16	---	Volts
	$I_F=6\text{A}$, $T_J = 25^\circ\text{C}$		---	1.34	1.50	
	$I_F=6\text{A}$, $T_J = 125^\circ\text{C}$,		---	1.67	---	
Reverse Current	$V_R=650\text{V}$, $T_J = 25^\circ\text{C}$	I_R	---	1.2	50	μA
	$V_R=650\text{V}$, $T_J = 125^\circ\text{C}$		---	4.5	---	

Dynamic Characteristics ($T_C = 25^\circ\text{C}$ unless otherwise specified)

Characteristics	Test Conditions	Symbol	Min.	Typ.	Max.	Units
Total Capacitive Charge	$V_R=400\text{V}$, $T_J=25^\circ\text{C}$	Q_C	---	18	---	nC
Total Capacitance	$V_R=1\text{V}$, $f=1\text{ MHz}$	C	---	261	---	pF
	$V_R=200\text{V}$, $f=1\text{ MHz}$		---	35	---	
	$V_R=400\text{V}$, $f=1\text{ MHz}$		---	33	---	

2. Characteristics Curves

Ratings and Characteristics Curves, at $T_A = 25^\circ\text{C}$ unless otherwise specified

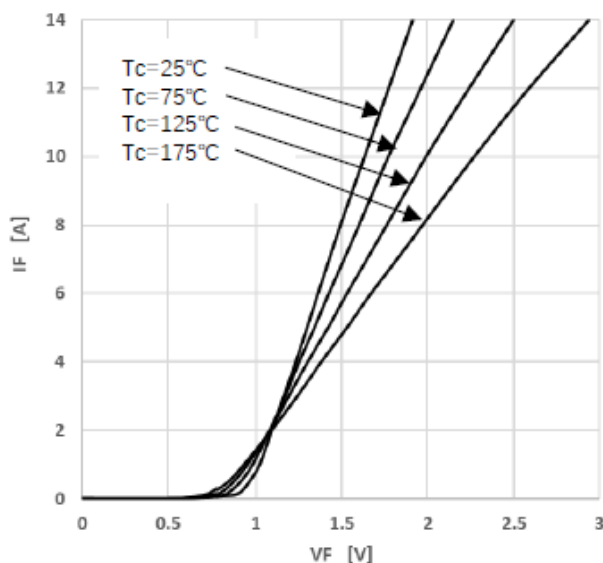

Fig. 1: Forward Characteristics

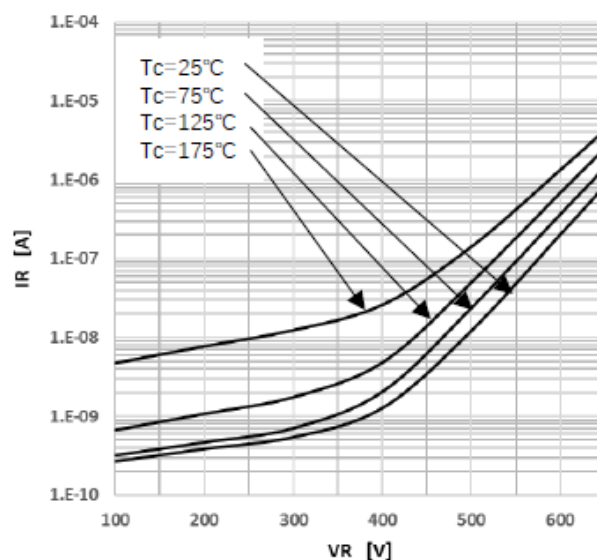

Fig. 2: Reverse Characteristics



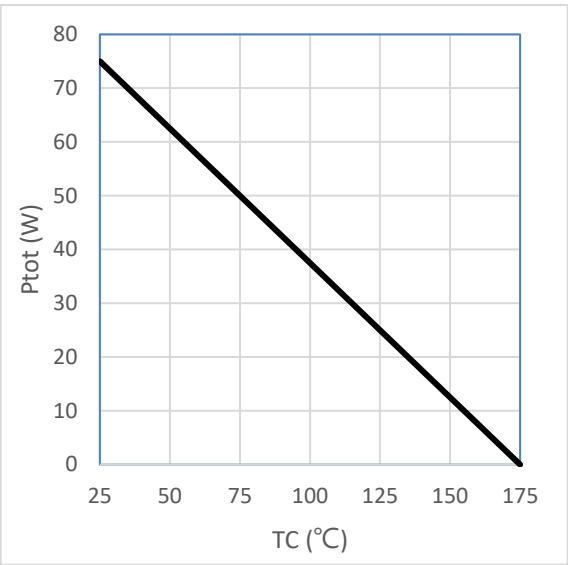

Fig 3: Power Dissipation

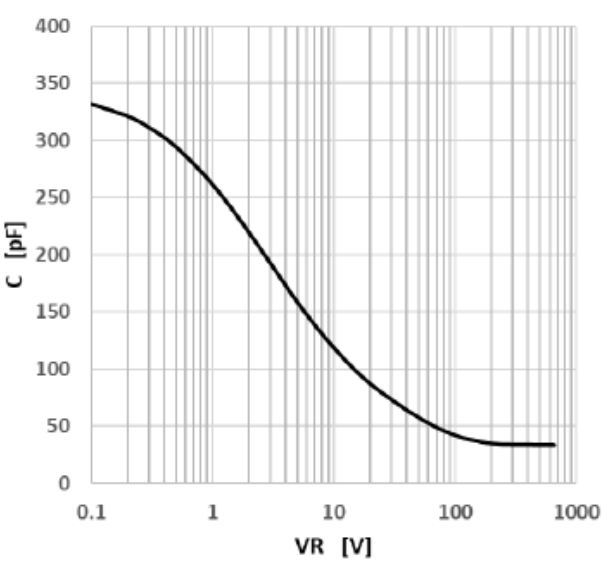

Fig 4: Typical Capacitance

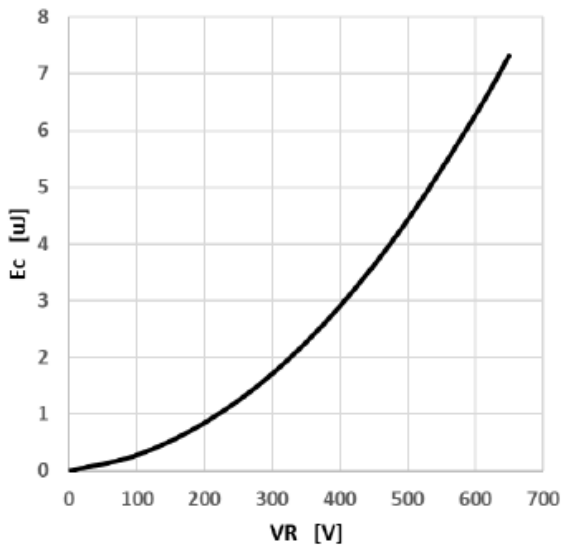

Fig 5: Typical Capacitance Stored Energy

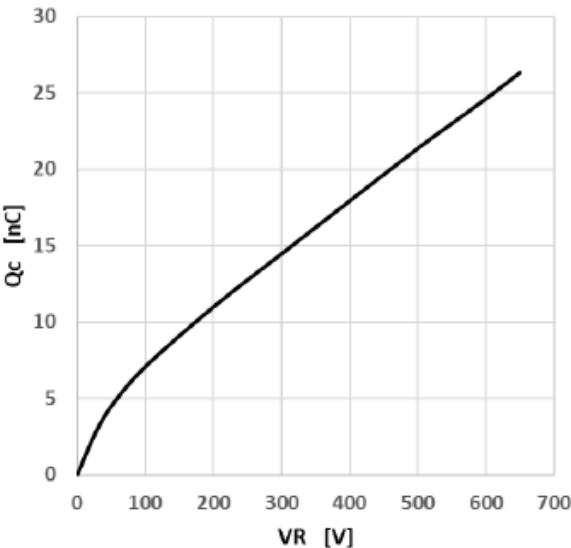
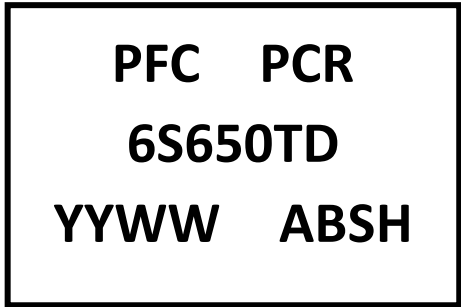

Fig 6: Capacitive Charge



3. Marking information

Top Marking Rule



PCR6S650TD = Product Type Marking Code
YYWW = Date Code
YY = Last two digits of year
WW = Week code
AB = Assembly code
S = Series Number
H = Halogen Free (N/A = common molding compound)

4. Package information

Package Outline Dimensions millimeters

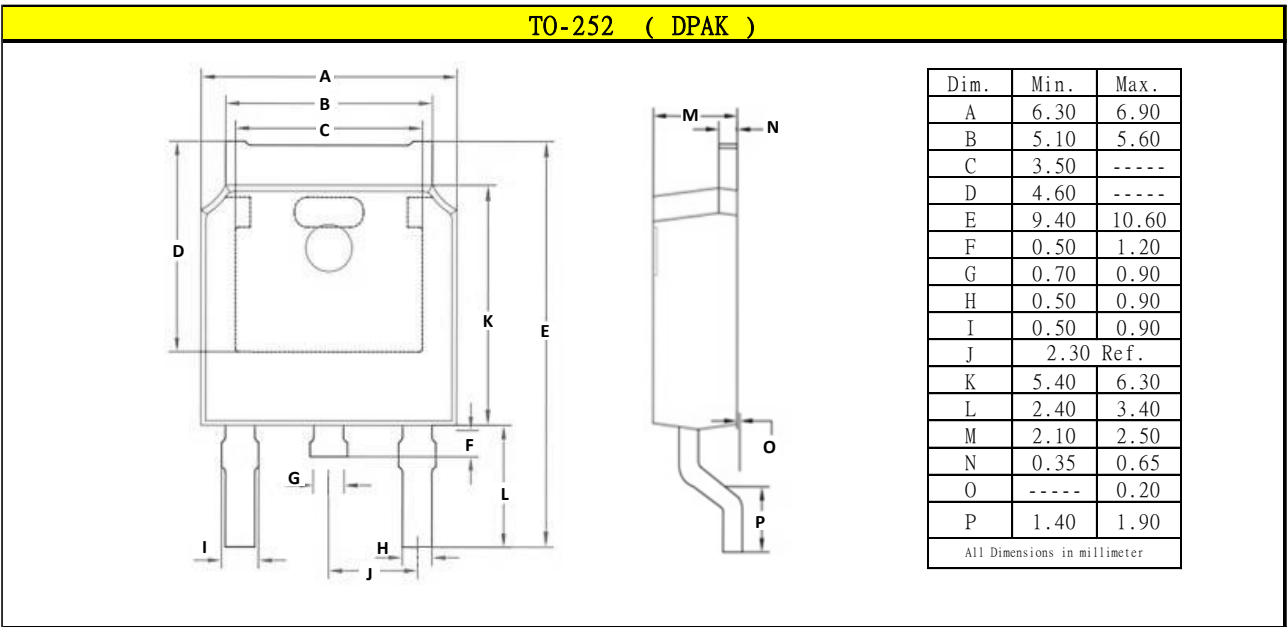

5. Ordering information

Part Number	Package	Delivery mode
PCR6S650TD	TO-252 (D-PAK)	2500 pcs / 13" diameter reel

Mechanical

- Molder Plastic: UL Flammability Classification Rating 94V-0
- Device Weight : 0.01 ounces (0.3grams) - TO-252

PFC Device Corp reserves the right to make changes without further notice to any products herein. PFC Device Corp makes no warranty, representation or guarantee regarding the suitability of its products for any particular purpose, nor does PFC Device Corp assume any liability arising out of the application or use of any product or circuit, and specifically disclaims any and all liability, including without limitation special, consequential or incidental damages. "Typical" parameters which may be provided in PFC Device Corp data sheets and/or specifications can and do vary in different applications and actual performance may vary over time. All operating parameters, including "Typical" must be validated for each customer application by customer's technical experts. PFC Device Corp does not convey any license under its patent rights nor the rights of others. PFC Device Corp products are not designed, intended, or authorized for use as components in systems intended for surgical implant into the body, or other applications intended to support or sustain life, or for any other application in which the failure of the PFC Device Corp product could create a situation where personal injury or death may occur. Should Buyer purchase or use PFC Device Corp products for any such unintended or unauthorized application, Buyer shall indemnify and hold PFC Device Corp and its officers, employees, subsidiaries, affiliates, and distributors harmless against all claims, costs, damages, and expenses, and reasonable attorney fees arising out of, directly or indirectly, any claim of personal injury or death associated with such unintended or unauthorized use, even if such claim alleges that PFC Device Corp was negligent regarding the design or manufacture of the part.

